

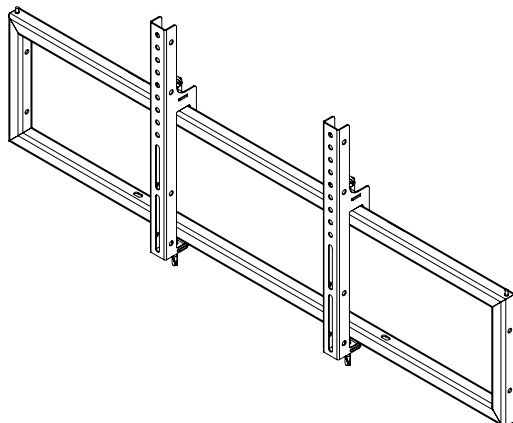

Installation Instructions for AV/VC One Screen Mount Kit

AVS/021/SMK1



**REFER ALSO TO MAIN
INSTALLATION INSTRUCTIONS
FOR AV/VC ONE**



IMPORTANT NOTE

For dual screen installations you
will require 2x AVS/021/SMK1

PARTS INCLUDED:

AVS/021/SMK1

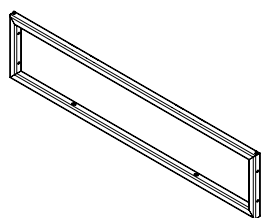

Screen Frame

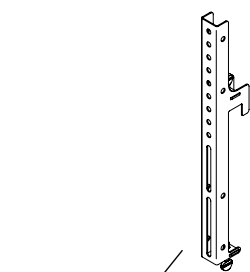

VESA Rail x2



Screw x2



VESA fixing kit



Washer x4



Hex Nut x2

⚠ WARNING

- Single Screen Installation: 80" max size. 90kg (198lbs) max weight.
- Dual screen installation: 65" max size. 60kg (132lbs) max weight per screen.
- Use with products heavier than the maximum weights indicated may result in instability causing possible injury.
- Correct installation is essential to safe and reliable operation of the AV/VC One product and falls outside the scope of responsibility of Colebrook Bosson Saunders. Please follow assembly instructions carefully.
- Do not use this product for any purpose other than that for which it was designed.
- Ensure that floor or wall surface is strong enough to support the weight of the fully-loaded AV/VC One and that the floor surface is flat and level.
- Do not install AV/VC One outdoors or in environments where it will be directly exposed to moisture or highwinds.
- Follow the manufacturer's guidance for mounting of monitors, displays and other equipment.
- Please take care to avoid trapping fingers when installing or adjusting the product.

⚠ ELECTRICAL SAFETY

- Safe installation of electrical equipment is the responsibility of the installer.
- Colebrook Bosson Saunders recommends that only double-insulated electrical equipment and cables are installed in AV/VC One unit.

⚠ MAINTENANCE AND INSPECTION

- Ensure all screws and fixings are fully tightened and occasionally re-tighten if necessary.
- Clean with a dampcloth. DO NOT use solvents.

⚠ DISCLAIMER

As part of Colebrook Bosson Saunders ongoing product improvement programme, the design of products may change without prior notice and details may vary from those illustrated.

PATENTS

Colebrook Bosson Saunders hold a number of patents and other intellectual property rights covering our products and processes. You can find patent information on our website at:
www.colebrookbossonsaunders.com/patents



colebrook bosson saunders

Single screen or dual screen configuration?

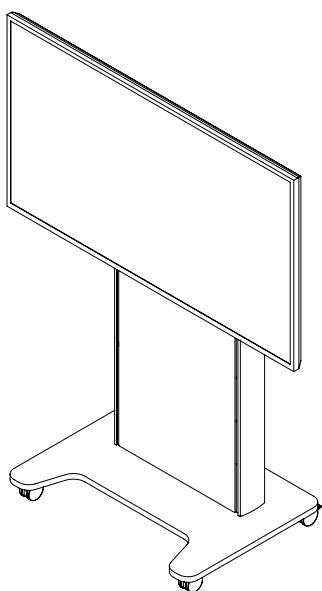

FOR SINGLE SCREEN
INSTALLATION
GO TO SECTION

1

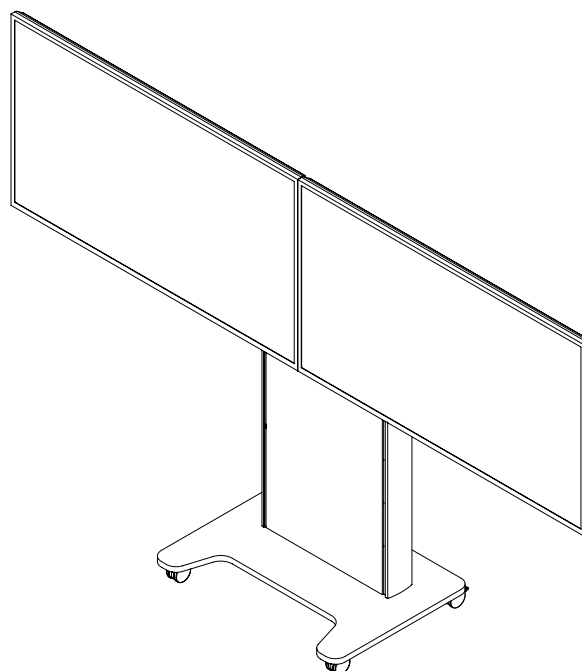

FOR DUAL SCREEN
INSTALLATION
GO TO SECTION

4



IMPORTANT

SINGLE SCREEN INSTALLATION

80" MAX SIZE
90KG (198LBS) MAX WEIGHT

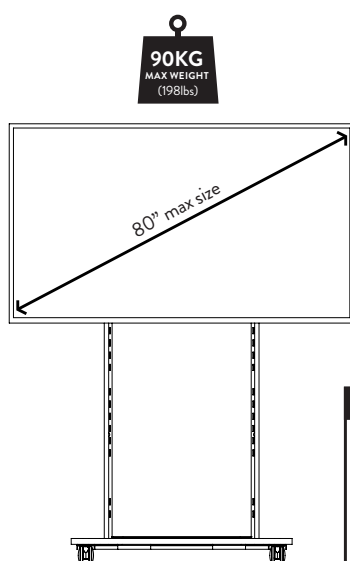

DUAL SCREEN INSTALLATION

65" MAX SIZE
60KG (132LBS) MAX WEIGHT

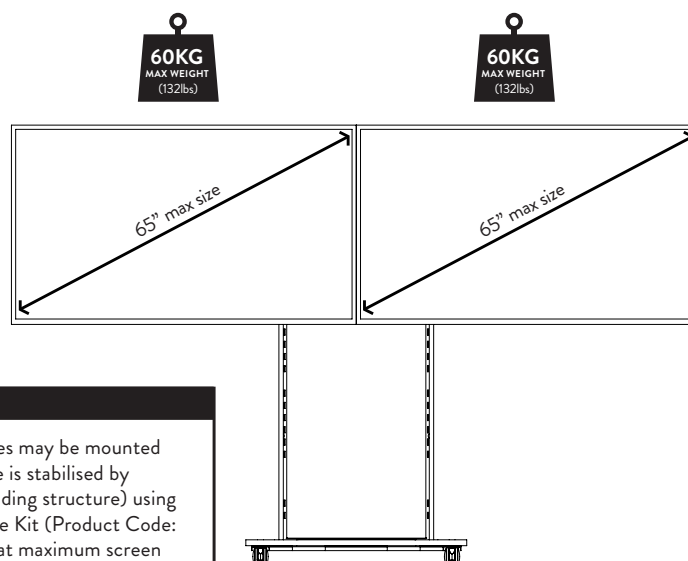

IMPORTANT NOTE

Note that larger screen sizes may be mounted but only if the AV/VC One is stabilised by securing to the wall (or building structure) using the AV/VC One Wall Brace Kit (Product Code: AVS/021/WBK1). Note that maximum screen weight limits still apply, regardless of screen size.



IT IS RECOMMENDED THAT SCREENS ARE REMOVED BEFORE MOVING THE AV/VC ONE UNIT

1.1 INSTALL SCREEN FRAME TO SCREEN SUPPORT BRACKETS

1.1A

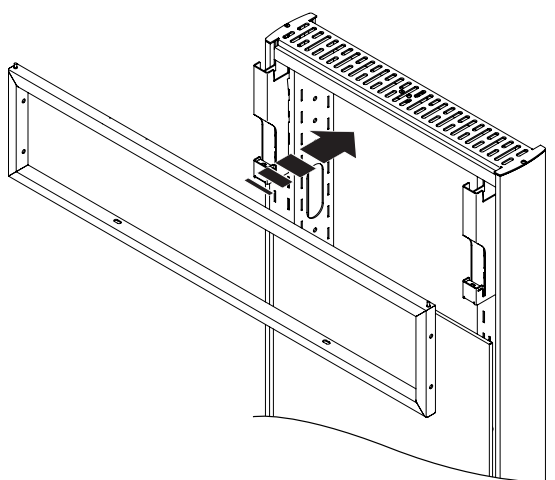

1.1B

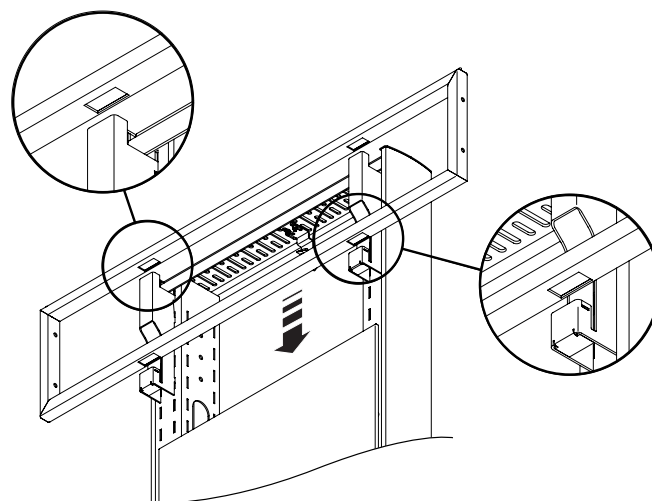

IMPORTANT NOTE
Ensure all brackets slide into rectangular cutouts

1.1C

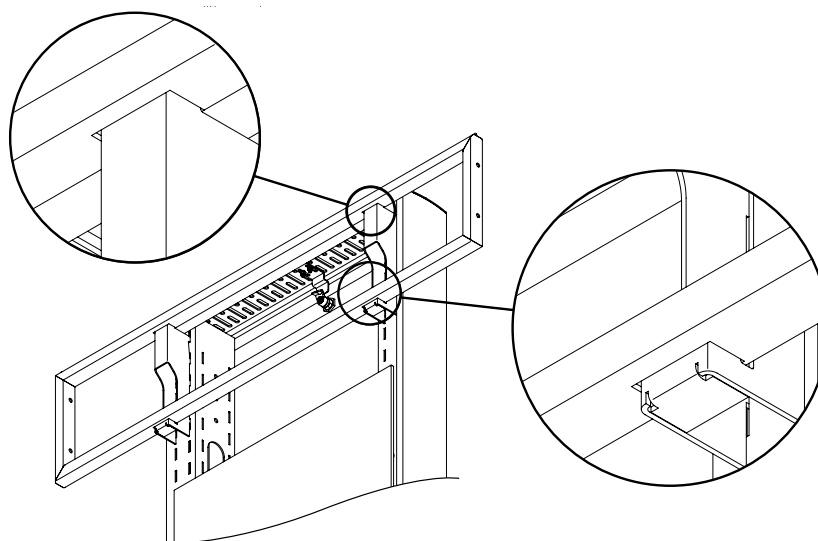

1.2 FIX SCREEN FRAME TO SCREEN SUPPORT BRACKETS

Fixing screws are supplied with main AV/VC One structure

IMPORTANT NOTE
Ensure both fixing screws are fully tightened

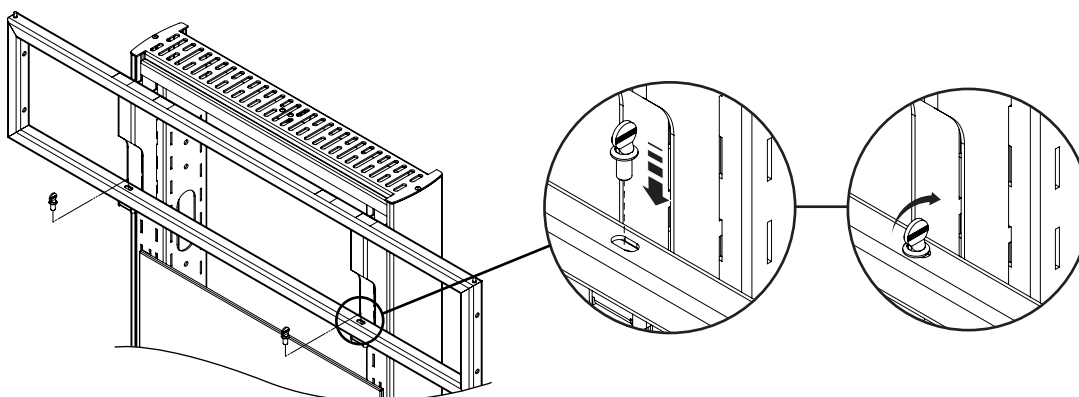

2.1

PLAN MOUNTING POSITION (IF NECESSARY)

Depending on the VESA size of your screen, you may need to consider the mounting position of the VESA rails. This will ensure the correct final screen position

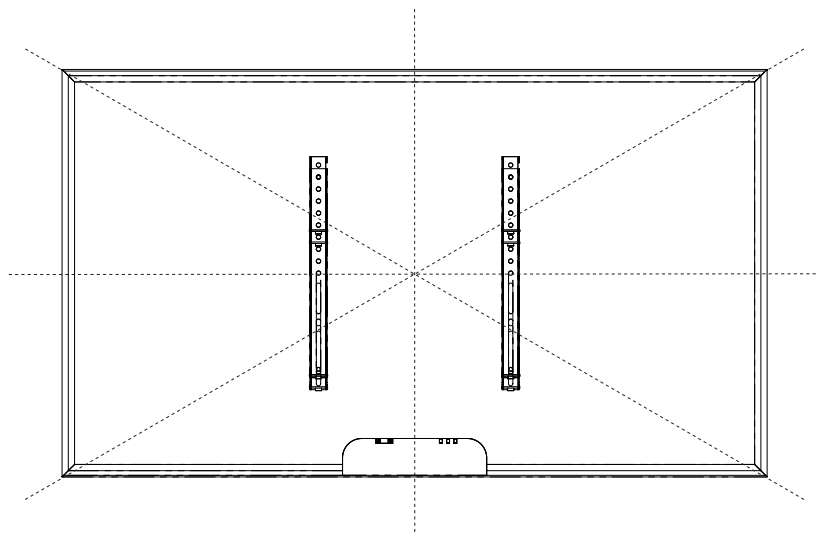

2.2

FIX VESA RAILS TO THE SCREEN

IMPORTANT NOTE

Carefully select fixing screws to suit screen being mounted

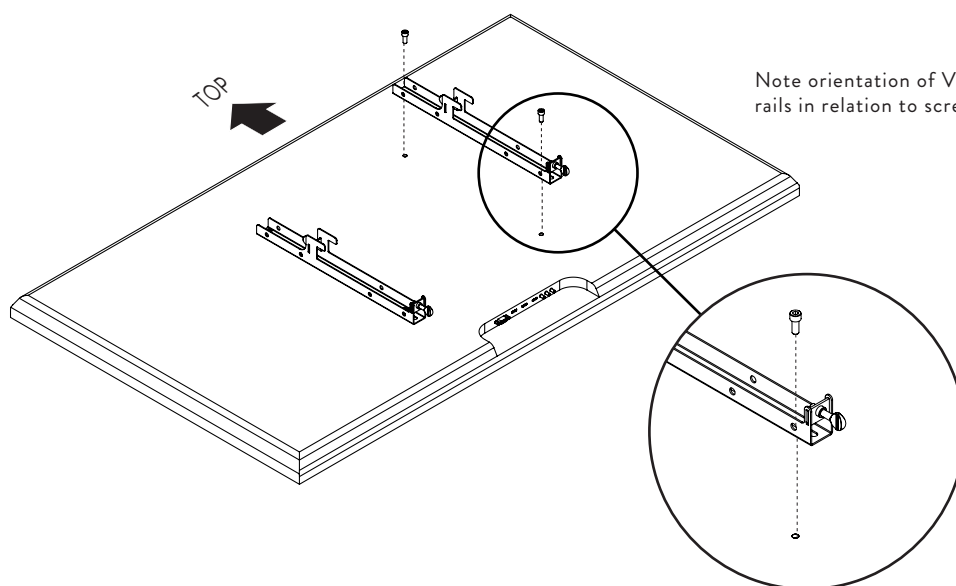

Note orientation of VESA rails in relation to screen

INSTALLING A CAMERA MOUNT?

If your AV/VC One installation requires a Camera Mount please install it at this stage **BEFORE** mounting the screens

YOU WILL NEED:

AV/VC One - Camera Mount Kit
AVS/021/CAM1

SEE INSTALLATION
INSTRUCTIONS
SUPPLIED WITH
CAMERA MOUNT



3.1 INSTALL SCREEN ONTO SCREEN FRAME

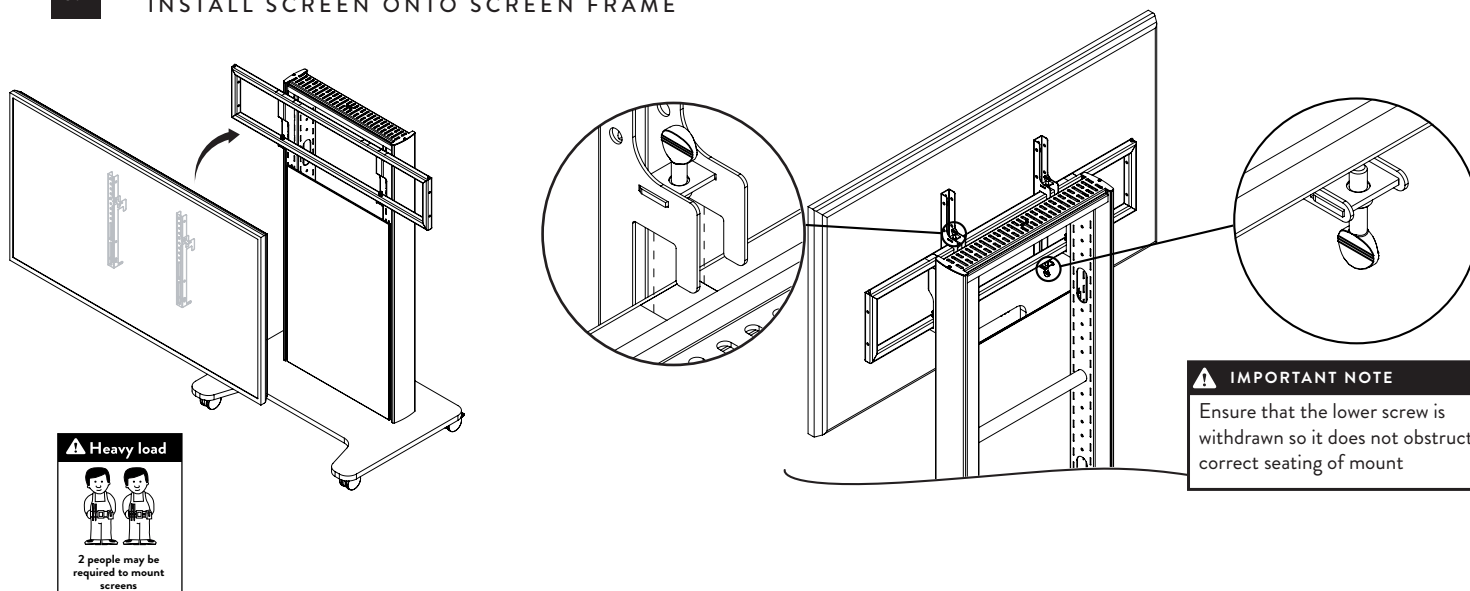

3.2 LEVEL SCREEN IF REQUIRED (OPTIONAL)

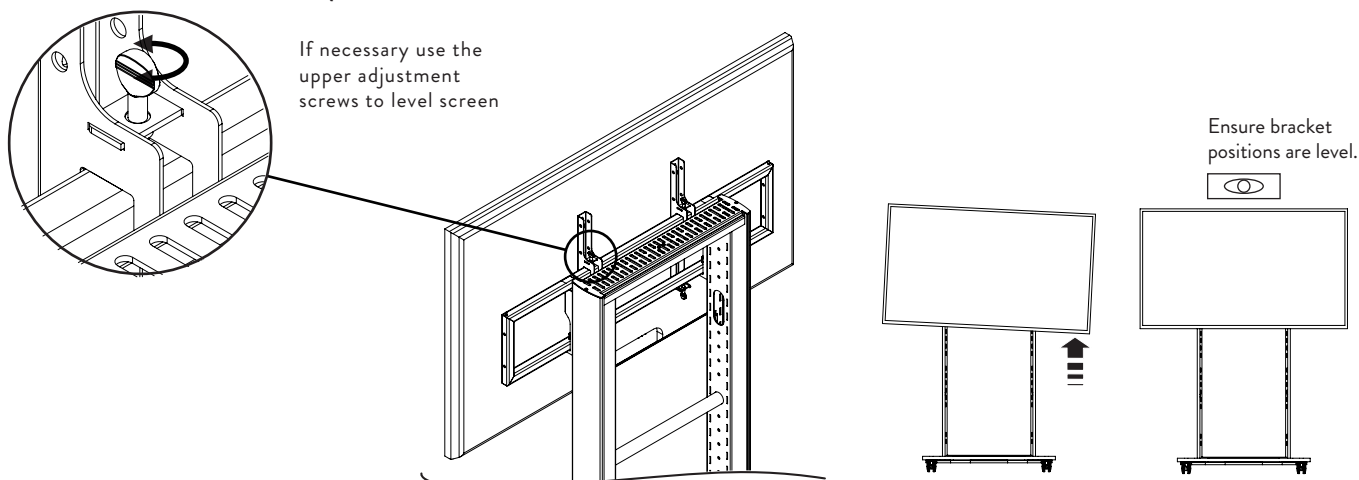

3.3 SECURE SCREEN TO SCREEN FRAME

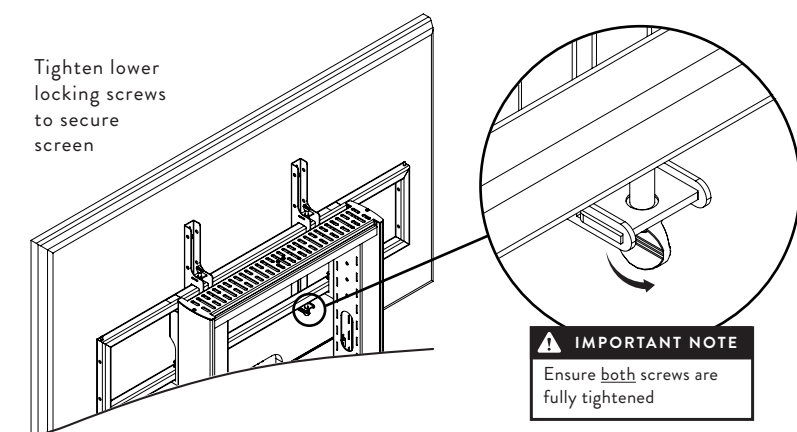

3.4 SCREEN IS NOW INSTALLED

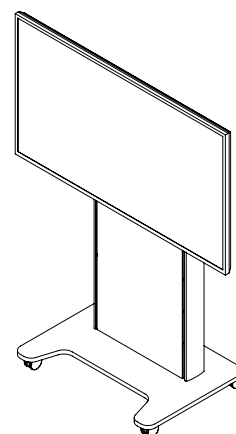

SINGLE SCREEN INSTALLATION IS NOW COMPLETE



PLEASE CONSIDER LEAVING THESE INSTRUCTIONS WITH THE UNIT IF FURTHER INSTALLATION MAY BE REQUIRED BY OTHERS

4.1 FIX 2X SCREEN FRAMES TOGETHER

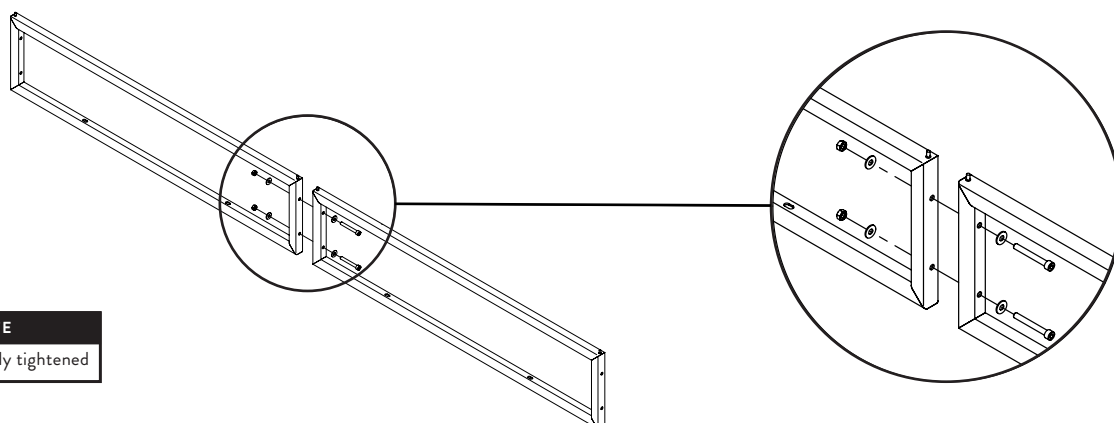

IMPORTANT NOTE
Ensure all fixings are fully tightened

4.2 INSTALL SCREEN FRAMES TO SCREEN SUPPORT BRACKETS

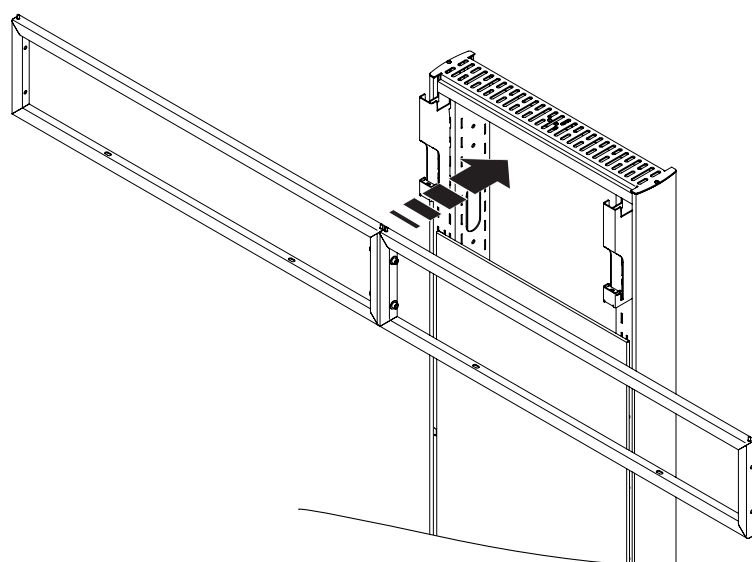

IMPORTANT NOTE
Ensure all brackets slide into rectangular cutouts

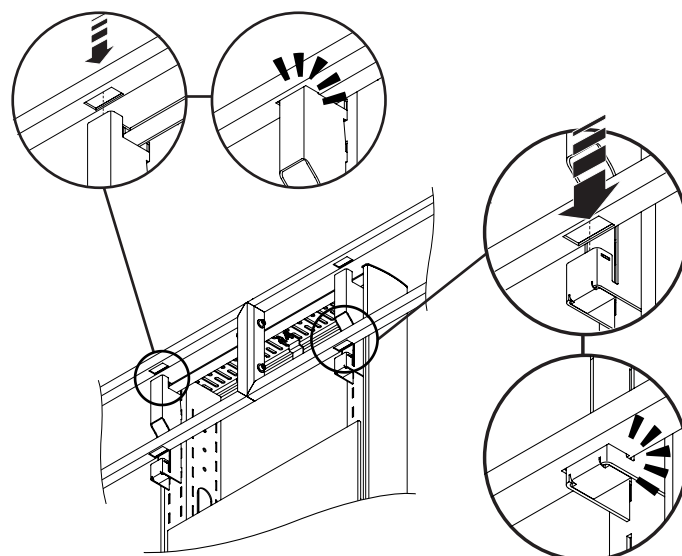

4.3 FIX SCREEN FRAMES TO SCREEN SUPPORT BRACKETS

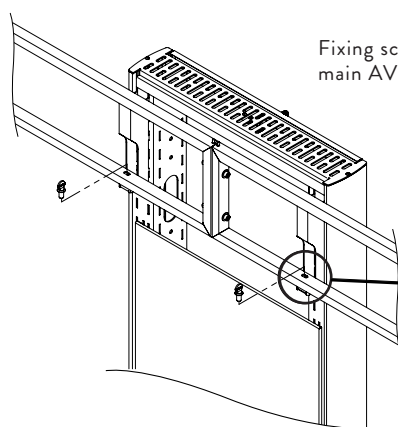

Fixing screws are supplied with main AV/VC One structure

IMPORTANT NOTE
Ensure both fixing screws are fully tightened

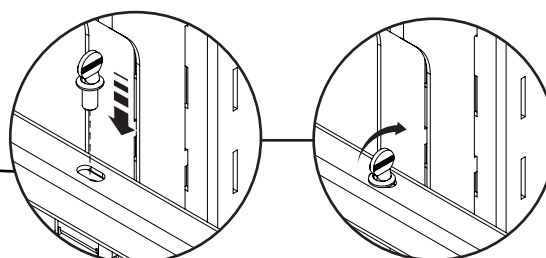

5.1

PLAN MOUNTING POSITION (IF NECESSARY)

Depending on the VESA size of your screen, you may need to consider the mounting position of the VESA rails. This will ensure the correct final screen position.

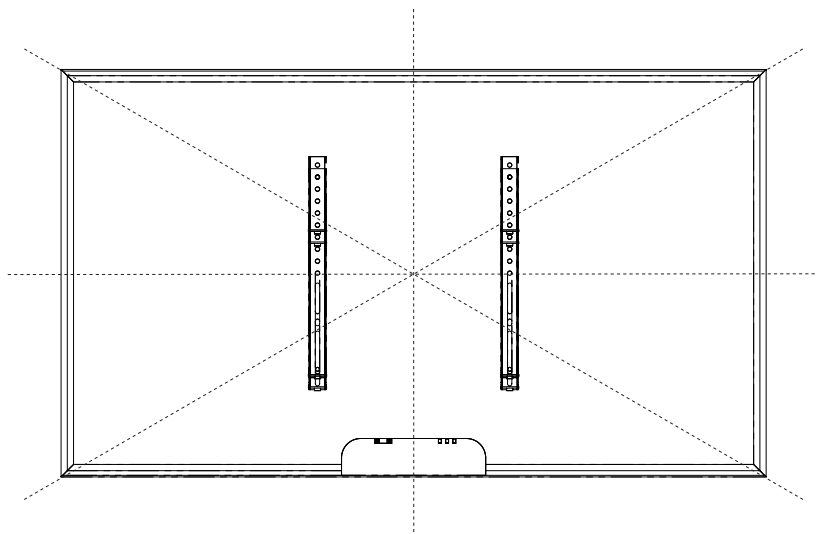

5.2

FIX VESA RAILS TO THE SCREEN

IMPORTANT NOTE

Carefully select fixing screws to suit screen being mounted

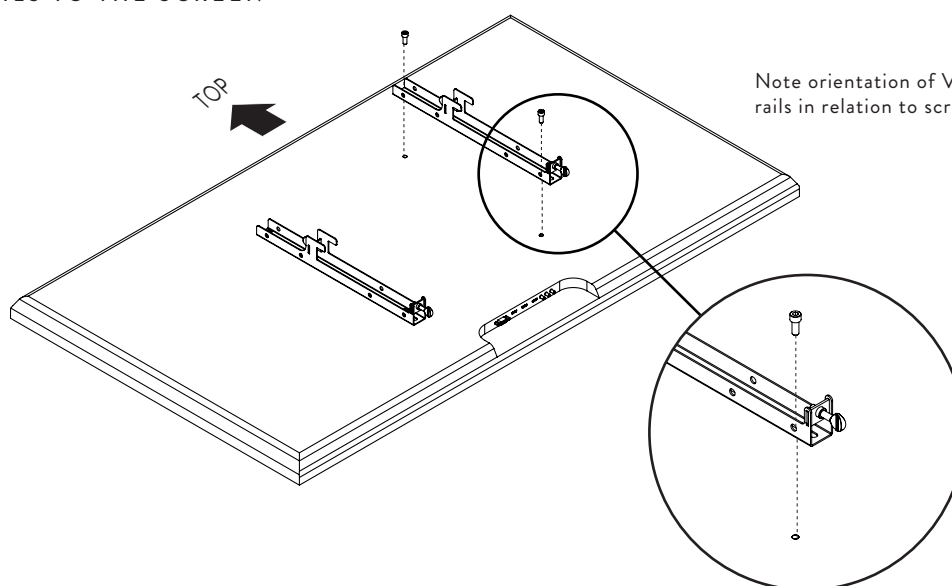

Note orientation of VESA rails in relation to screen

INSTALLING A CAMERA MOUNT?

If your AV/VC One installation requires a Camera Mount please install it at this stage **BEFORE** mounting the screens

YOU WILL NEED:

AV/VC One - Camera Mount Kit
AVS/021/CAM1

SEE INSTALLATION
INSTRUCTIONS
SUPPLIED WITH
CAMERA MOUNT



6.1 INSTALL BOTH SCREENS ONTO SCREEN FRAME

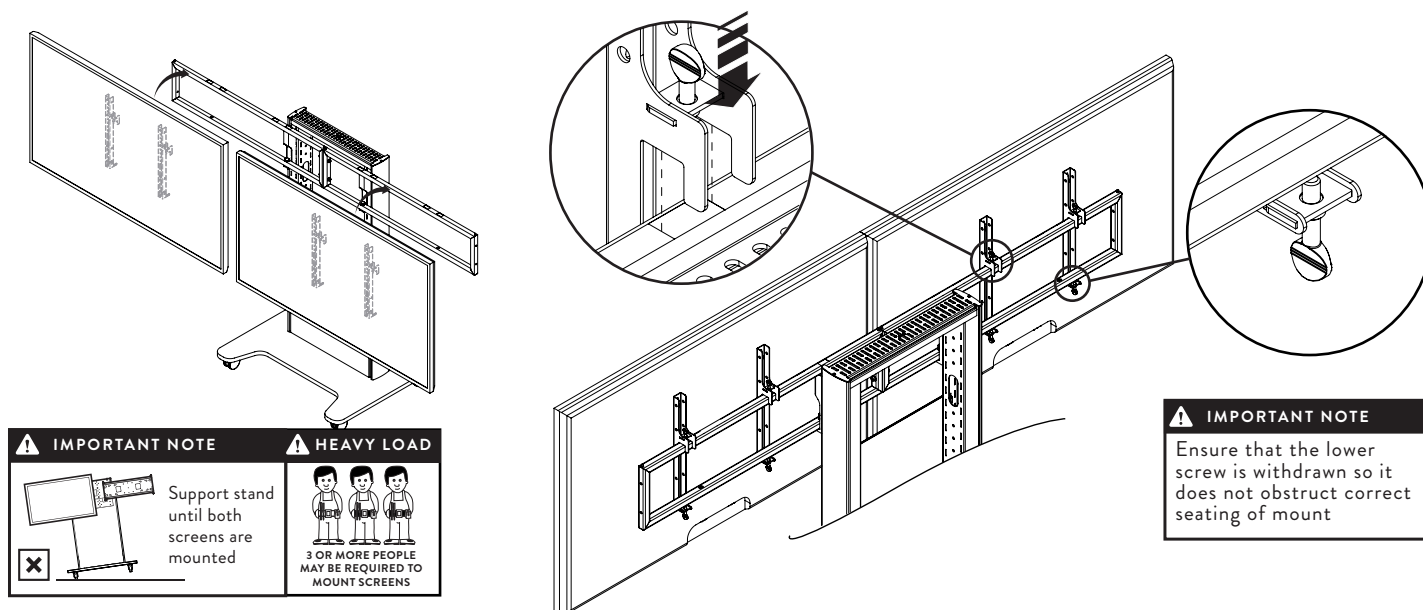

6.2 POSITION SCREENS

Carefully slide screens on frame to desired position

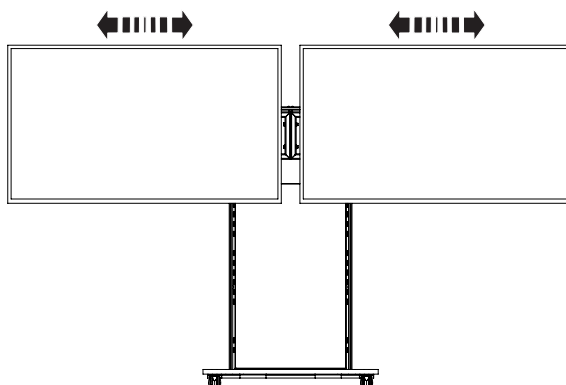

6.3 LEVEL SCREENS IF NECESSARY

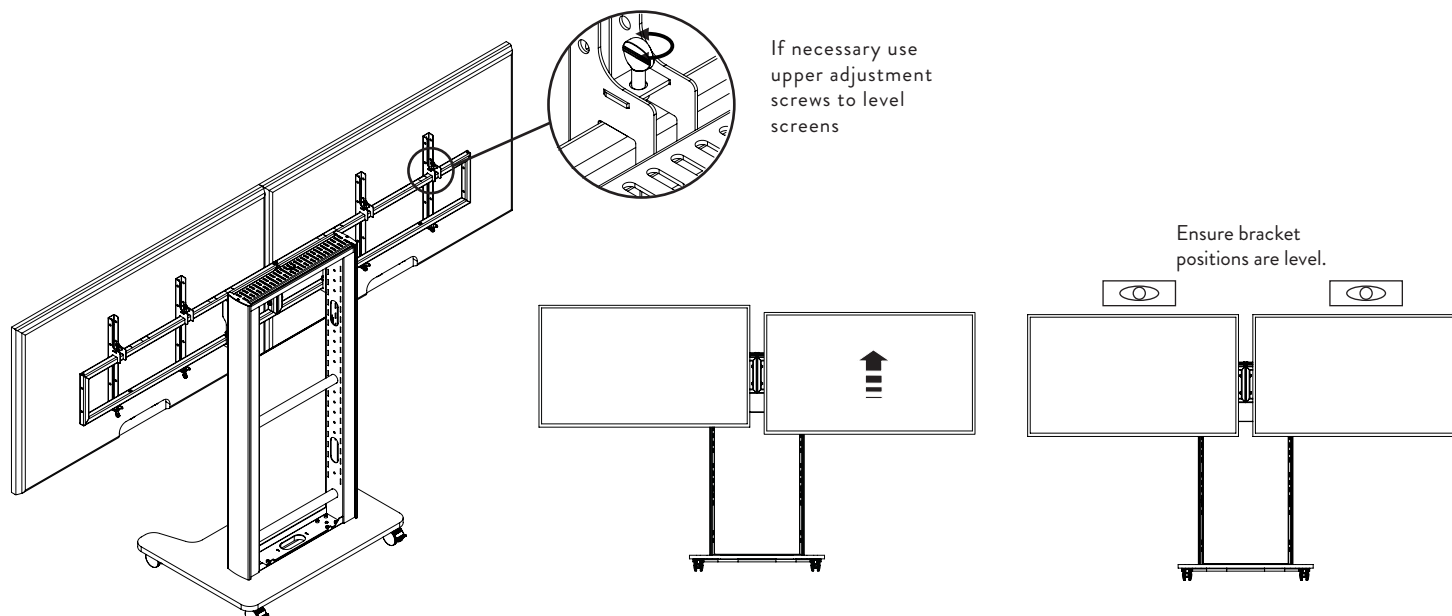

6.4

SECURE SCREENS TO SCREEN FRAME

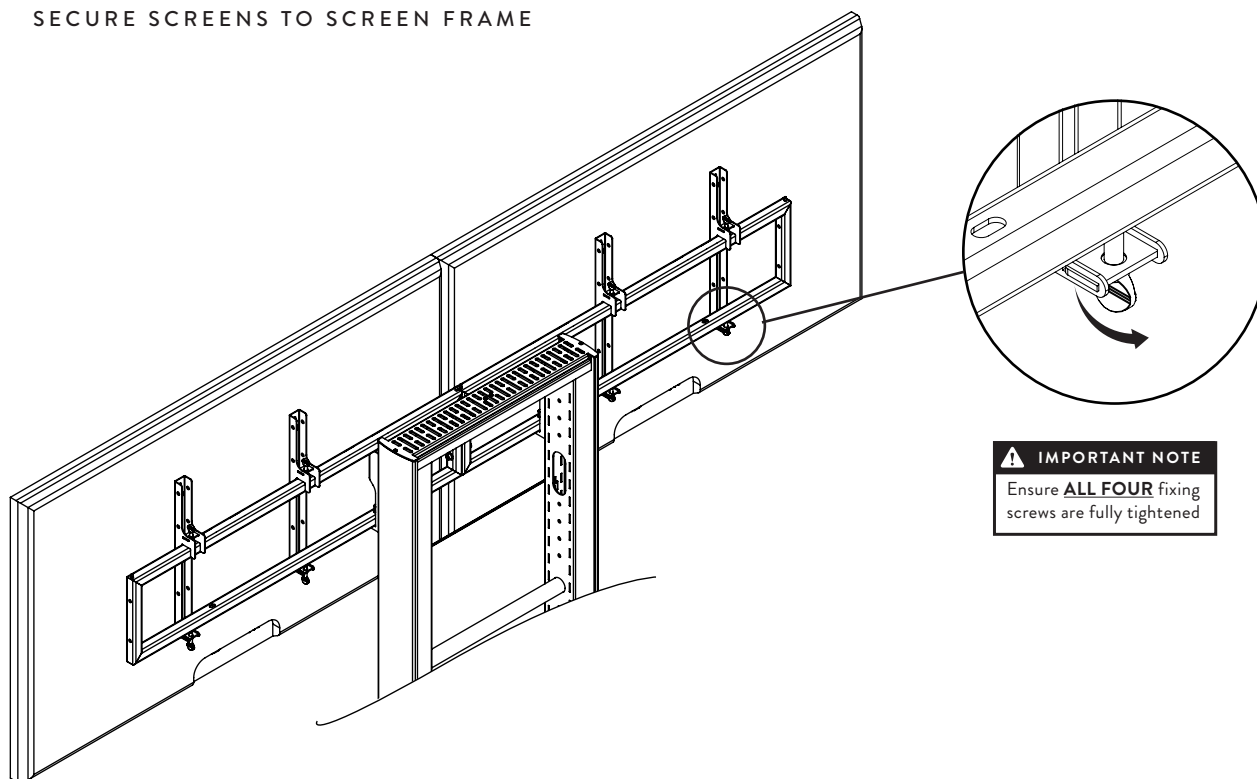

6.5

SCREENS ARE NOW INSTALLED

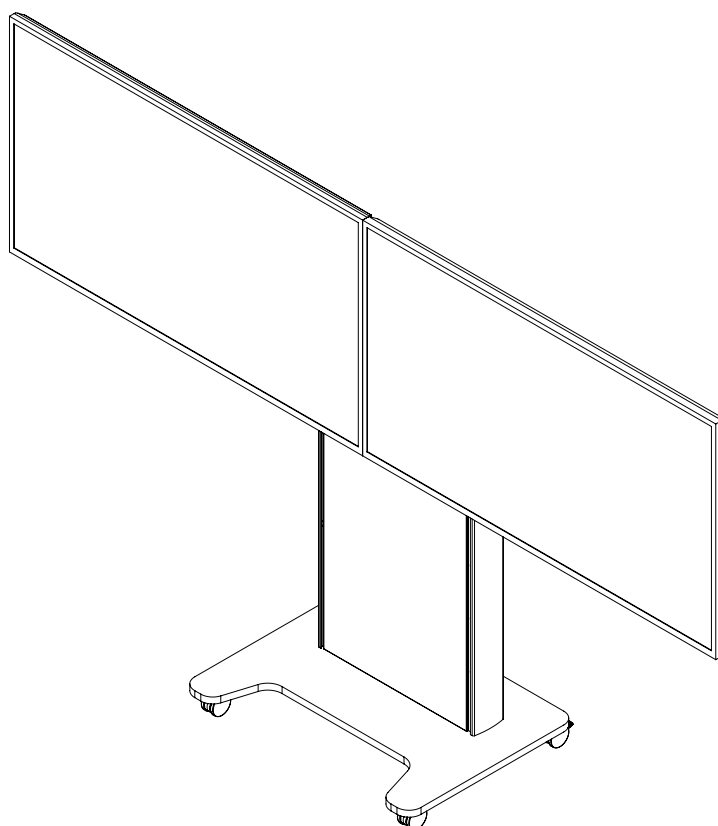

DUAL SCREEN INSTALLATION IS NOW COMPLETE



PLEASE CONSIDER LEAVING THESE INSTRUCTIONS WITH THE UNIT
IF FURTHER INSTALLATION MAY BE REQUIRED BY OTHERS

