

Universal Wall Mount Bracket Instructions (UNI/SWB/002)

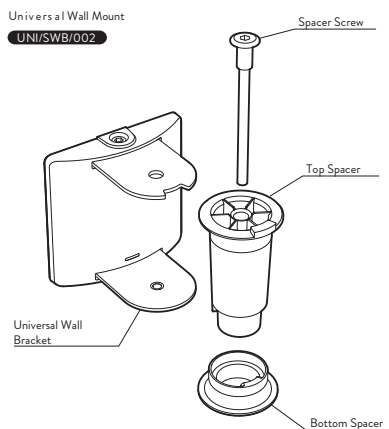

Universal Wall Mount
UNI/SWB/002



WARNING

Before you start check to see the wall is strong enough to support the load

1 Remove cover & spacers from bracket

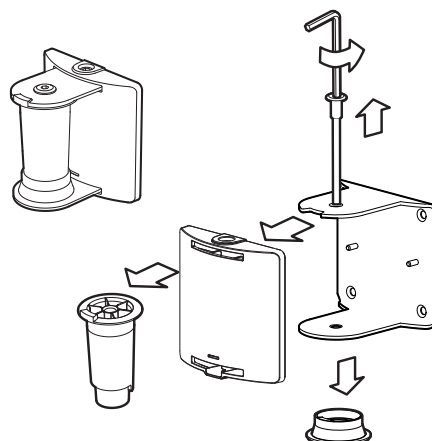

2 Mount bracket to wall

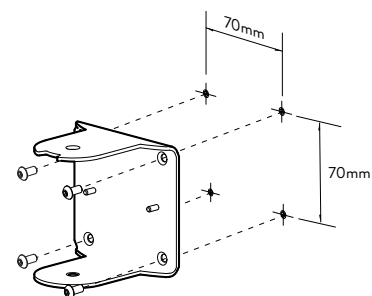

Fixings should be suitable for the surface you are mounting to and suitable for 12kg (26.5lbs) min

3 Fit cover to mount

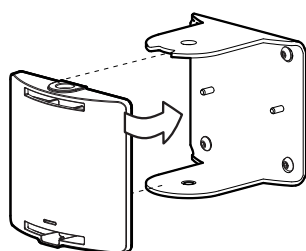

4 Add spacers to arm

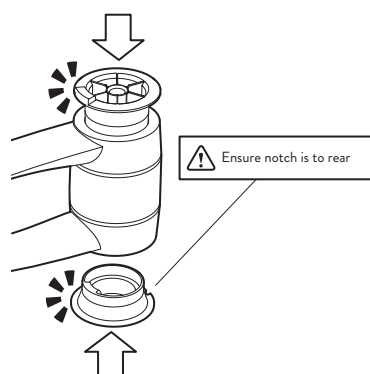

5 Add arm to the bracket and insert spacer screw

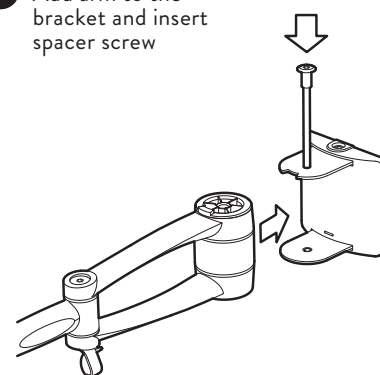

6 Tighten spacer screw

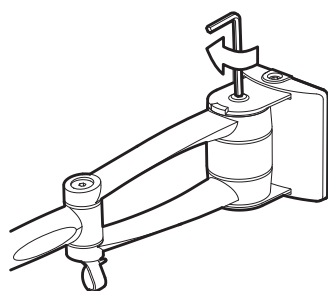

Maximum Loading

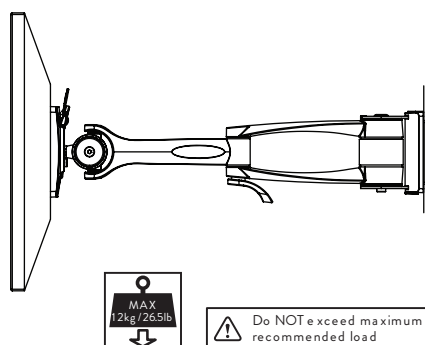

WARNING

- Ensure the wall is suitable to take the weight of the screen and mounting
- Do not use this product for any purpose other than that for which it was designed
- Hold the screen tightly when making adjustments
- Care should be taken to avoid trapping fingers
- Do not dismantle or modify the screen mounting
- Supported weight must not exceed 12Kg (26.5lb)

MAINTENANCE AND INSPECTION

- Ensure all screws are tightened and occasionally adjust if needed
- Clean with a damp cloth, NO solvents

DISCLAIMERS

- The use of power tools, lever bars or excessive force during the installation, or re-configuration of the product will invalidate your guarantee
- Failure to observe the recommendations in the use, and configuration of these products may affect your guarantee

PATENTS

Colebrook Bosson Saunders hold a number of patents and other intellectual property rights covering our products and processes. You can find patent information on our website at: www.colebrookbossonsaunders.com/patents

Please consider leaving these instructions with the product if further installation may be required by others