

Multi slatwall mount
standard

UNI/MSB/002

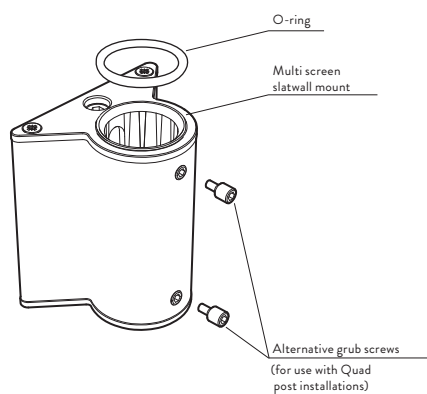

Attaching bracket to slatwall

1-1 Offer to slatwall

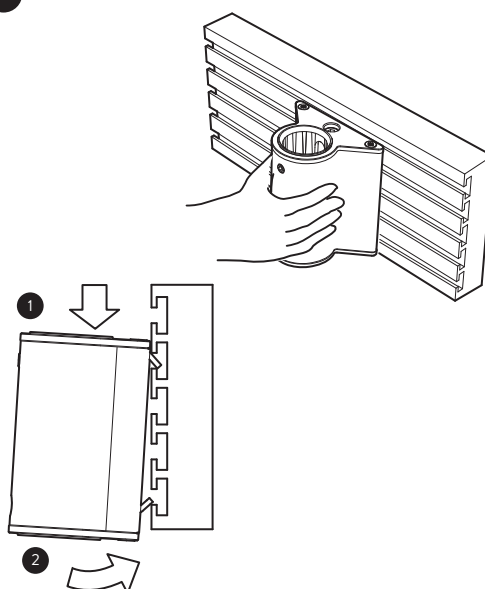

1-2 Tighten the bracket onto the slatwall

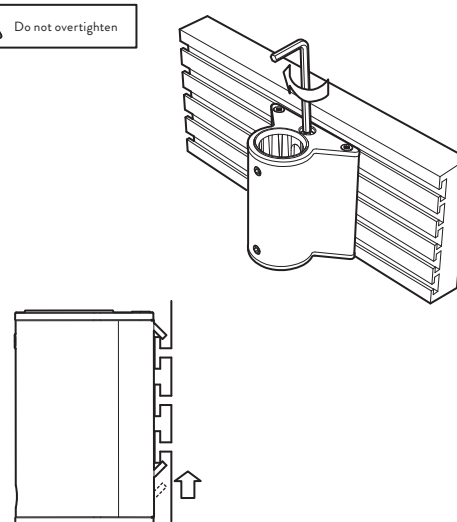
 Do not overtighten

Installing post

2-1 Insert post and tighten grub screws

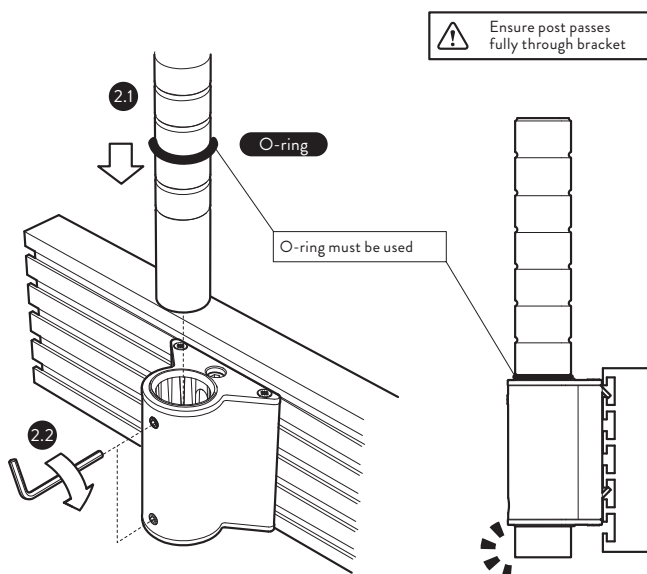

Adding arm

3-1 Set the clip at desired height and drop arm onto the post

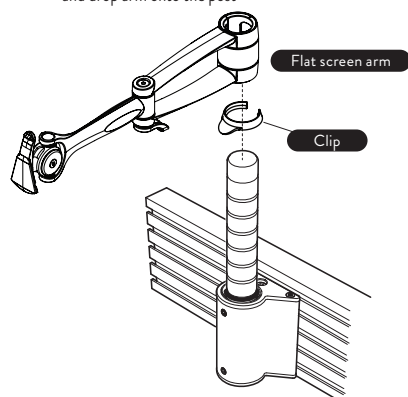

3-2 Maximum loading

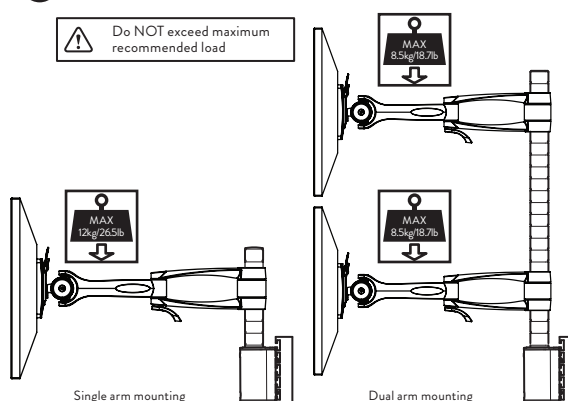
 Do NOT exceed maximum recommended load

WARNING

- Ensure the slatwall is suitable to take the weight of the screen and mounting
- Do not use this product for any purpose other than that for which it was designed
- Hold the screen tightly when making adjustments.
- Care should be taken to avoid trapping fingers.
- Do not dismantle or modify the screen mounting.
- Supported weight must not exceed 12Kg (26.5lb) for single arm, 8.5kg (18.7lb) per arm for dual arm mounting

MAINTENANCE and INSPECTION

- Ensure all screws are tightened and occasionally adjust if needed
- Clean with a damp cloth, NO solvents.

DISCLAIMERS

- The use of power tools, lever bars or excessive force during the installation, or re-configuration of the product will invalidate your guarantee
- Failure to observe the recommendations in the use, and configuration of these products may affect your guarantee

PATENTS

Colebrook Bosson Saunders hold a number of patents and other intellectual property rights covering our products and processes. You can find patent information on our website at: www.colebrookbossonsaunders.com/patents

Please consider leaving these instructions with the product if further installation may be required by others